

FLOUNCE SCARF PATTERN

You will need a pair of US 7 needles & 2 balls of Flouce.

With US 7 needle cast on 6 sts following the illustration on the back of the Flouce label band.

Continue knitting as per the illustrations until you have almost used 2 balls of yarn. To finish simply tack down each loop one at a time on the back side of work.

This scarf will measure approximately 4" x 60".

Note scarf can be knitted wider and longer if desired.

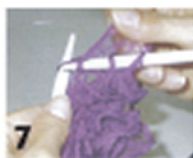
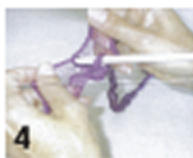
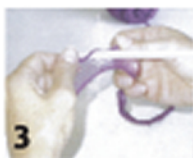

1. Finished scarf.

2. Open yarn carefully.

3 & 4. Put the knitting needle in the upper edge of the yarn.

5, 6 & 7. Knit one stitch after another at distance of about 3/4".

To finish, simply tack down each loop one at a time on the back side of work.